

12

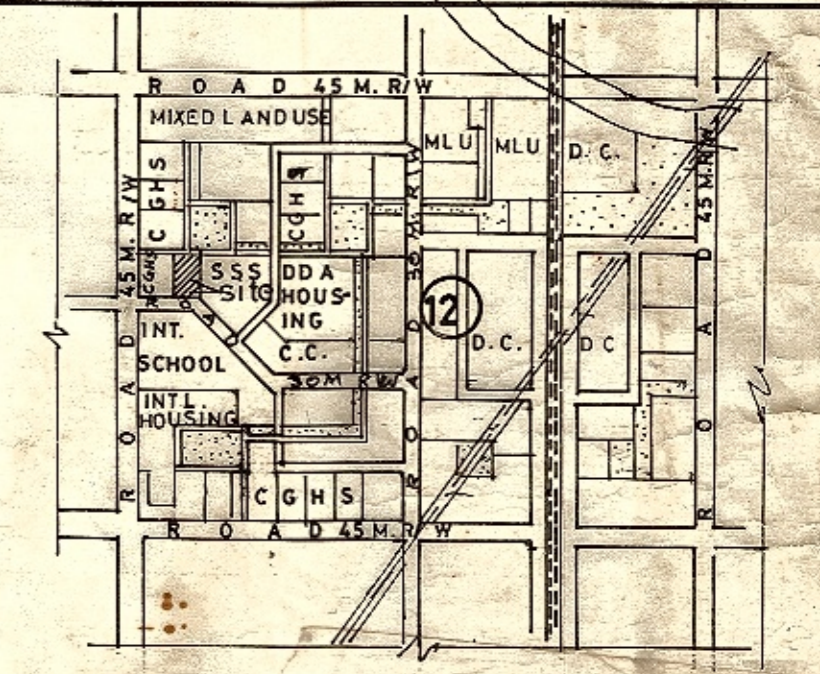
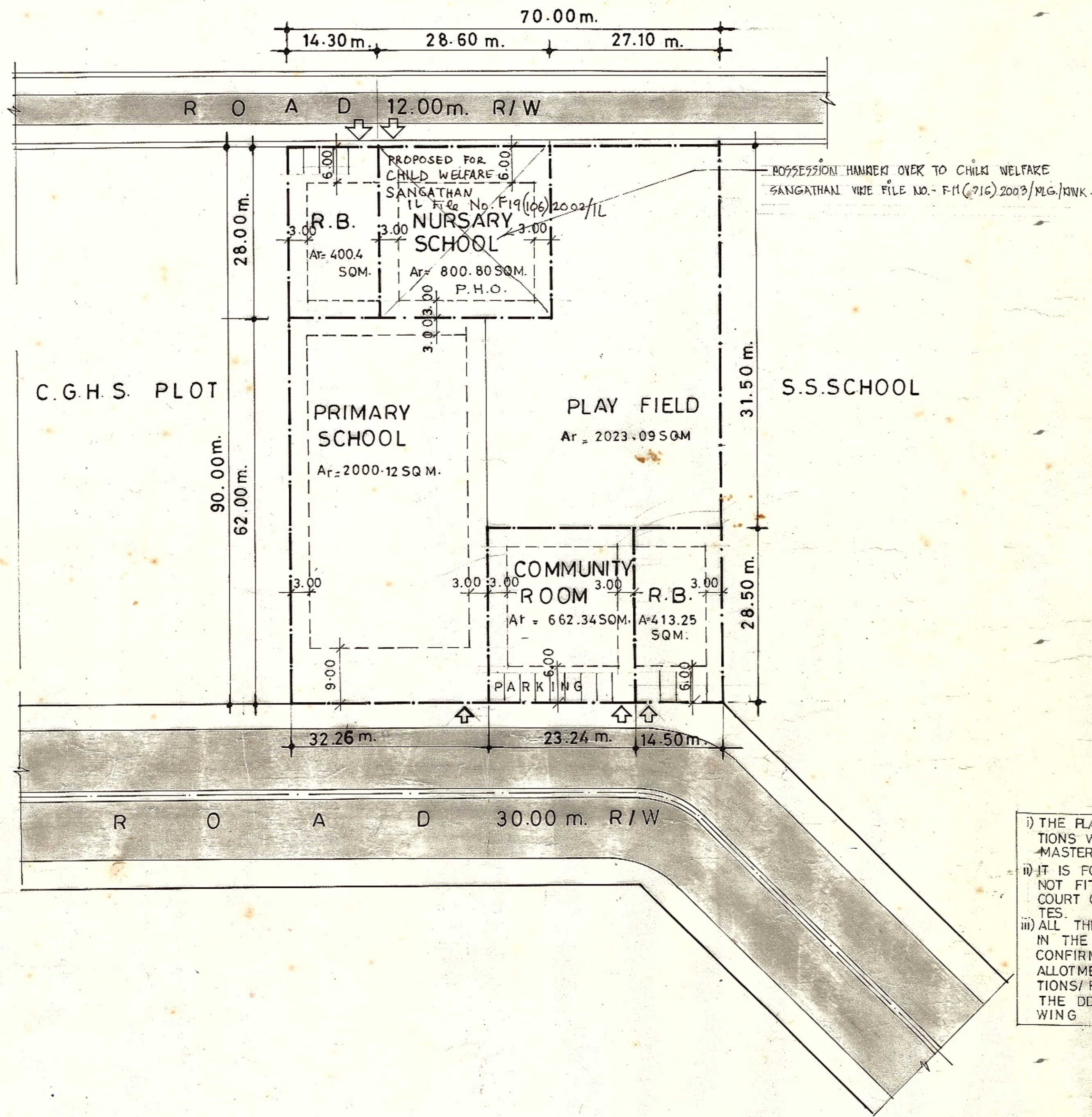

AREA STATEMENT
 TOTAL AREA OF THE PLOT 6300.00SQM

S.NO.	FACILITY	PROPOSED AREA IN SQM. OF EACH PLOT	GROUND COVERAGE	F.A.R.	MAX. HEIGHT
1.	PRIMARY SCHOOL	4023.21SQM	33%	100	14m.
2.	NURSARY SCHOOL	800.80SQM	33.33	66.66	11m.
3.	COMMUNITY ROOM	662.34SQM	33.33	66.66	8m.
4.	RELIGIOUS BUILDING I	413.25SQM	33.33%	66.66	8m.
5.	RELIGIOUS	400.40SQM	33.33%	66.66	8m.

NOTE: CHANGE OF NUMBERING FROM PH-6 TO PH-12 AND INCORPORATION OF PH-12 IN LAYOUT PLAN APPROVED BY DIR.(PLG) ON P. 6N IN FILE NO. F-8(10)94/DWK/HAF/B/Part

- i) THE PLAN IS SUBJECT TO MODIFICATIONS WITHIN THE FRAMEWORK OF MASTER PLAN/ZONAL PLAN.
- ii) IT IS FOR PLANNING PURPOSE & IS NOT FIT TO BE PRODUCED IN THE COURT OF LAW FOR PROPERTY DISPUTES.
- iii) ALL THE DIMENSIONS & AREA GIVEN IN THE PLAN ARE SUBJECT TO CONFIRMATION OF OWNERSHIP/ALLOTMENT STATUS AND DEMARCATATIONS/FEASIBILITY REPORT FROM THE DDA LANDS & ENGINEERING WING RESPECTIVELY.

* FEASIBILITY OBTAINED FROM E.E./WD-9/DDA
 LETTER NO. A-10/WD IX/DDA/(31)870 DATED 25-5-96
 - THE SCHEME HAS BEEN APPROVED BY V.C./DDA AT PAGE 6/N DT. 01.08.96 IN FILE NO. F-8(10)94/DWK/HAF(b)/Part I.

HOUSING AREA FACILITIES - Pocket - e

0 5 10 15 20 25 1:500 SCALE		SECTOR 42 Ph I
B. N. NAD	PLG. D/MAN	PWK/PKT-6/HAF/25/12/2021 DRG. NO.
T. SINGH ASSTT. DIRECTOR	ANIL BARAI JT. DIRECTOR	S. SRIVASTAVA DIRECTOR (PLG)

DWARAKA SUB-CITY (PAPANKALA)